

球墨铸铁法兰短管

Ductile Iron Flange Short Pipe

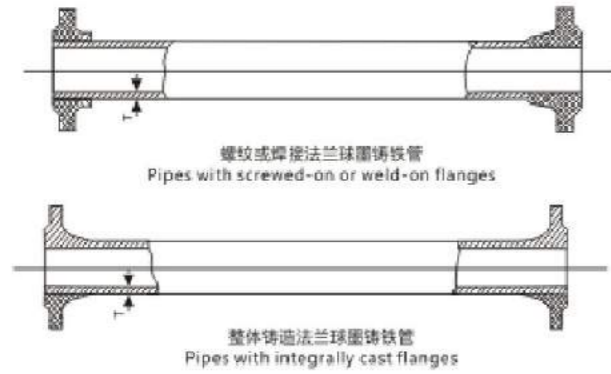

技术参数 SPECIFICATION

1. 测试标准/Type Test : EN14525/BS8561
2. 球墨铸铁/Ductile Iron : EN1563 EN-GJS-450-10
3. 涂层标准/Coating : WIS4-52-01
4. 球墨铸铁管用管件标准/Standard : EN545/ISO2531
5. 钻孔标准/Drilling Spec : EN1092-2

材质 MATERIALS

序号 ITEM	部件名称 PARTS	材质 MATERIAL
1	本体/Body	球墨铸铁/Ductile iron
2	密封圈/Seals	EPDM/NBR

规格DIMENSIONS(PN16)

DN	管子重量Pipe Mass				法兰重量Flange mass					
	K=12		K=14		铸造法兰Integral flange			螺纹或焊接法兰Screwed-on or weld on flanges		
	T	Mass/m	T	Mass/m	PN10	PN16	PN25	PN10	PN16	PN25
10	7	14.1	8.1	16.1	2.9	2.9	2.9	3.5	3.5	3.5
100	7.2	17.7	8.4	20.4	3.3	3.3	3.8	4	4	4.5
125	7.5	22.7	8.8	26.4	4	4	4.6	5	5	5.6
150	7.8	28	9.1	32.4	4.9	4.9	5.9	6.1	6.1	7.1
200	8.4	39.7	9.8	46.1	6.8	6.6	8.7	8.5	8.3	10.4
250	9	52.8	10.5	61.3	9.6	9.2	13.1	11.8	11.4	15.3
300	9.6	67.3	11.2	78.1	12.8	12.4	18	15.6	15.2	20.8
350	10.2	83.1	11.9	96.5	14.1	17.2	25.5	17.6	20.7	29
400	10.8	100	12.6	116.2	16.3	21.9	33.2	20.5	26.1	37.4
450	11.4	118.3	13.3	137.5	20.2	28.1	39		32.7	
500	12	138.2	14	160.6	21.8	37	48.7	27.6	42.8	54.5
600	13.2	181.8	15.4	211.3	30.8	57.3	71.5	38.4	64.9	79.1
700	14.4	230.8	16.8	268.4	40.5	55.6		50.2	65.3	
800	15.6	285.5	18.2	332.1	54.8	74		66.7	85.9	
900	16.8	345.4	19.6	401.7	64.3	88.2		78.7	102.6	
1000	18	410.6	21	477.7	81.4	122.9		98.6	140.1	
1100	19.2	481.7	22.4	560.4	112.8	147.8				
1200	20.4	557.7	23.8	649	120.9	185.2		144.2	208.5	
1400	22.8	726.8	26.6	845.7	147.8	215.2		178.2	246.3	
1500	24	819.1	28	953.2	201.4	289.3				
1600	25.2	916.9	29.4	1067	206.4	308.4		244.7	346.7	
1800	27.6	1129	32.2	1314	236.3	362.2		283.5	409.4	
2000	30	1363	35	1587	279.4	432.2		336.4	489.2	

球墨铸铁螺纹法兰盘

Ductile Iron Threaded Flange

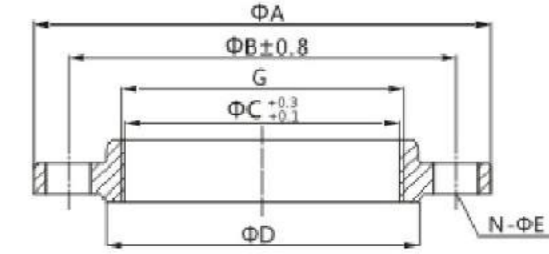

技术参数 SPECIFICATION

1. 测试标准/Type Test : EN14525/BS8561
2. 球墨铸铁/Ductile Iron : EN1563 EN-GJS-450-10
3. 涂层标准/Coating : WIS4-52-01
4. 球墨铸铁管用管件标准/Standard : EN545/ISO2531
5. 钻孔标准/Drilling Spec : EN1092-2

材质 MATERIALS

序号 ITEM	部件名称 PARTS	材质 MATERIAL
1	本体/Body	球墨铸铁/Ductile iron

规格DIMENSIONS(PN16)

DN	G	ΦA	ΦB	ΦC	ΦD	N	ΦE
DN50	1"	165	125	30.3	99	4	19
DN50	1 1/4"	165	125	39	99	4	19
DN50	1 1/2"	165	125	44.9	99	4	19
DN50	1 3/4"	165	125	50.9	99	4	19
DN50	2"	165	125	56.7	99	4	19
DN65	1"	185	145	30.3	118	4	19
DN65	1 1/4"	185	145	39	118	4	19
DN65	1 1/2"	185	145	44.9	118	4	19
DN65	1 3/4"	185	145	50.9	118	4	19
DN65	2"	185	145	56.7	118	4	19
DN80	1"	200	160	30.3	132	8	19
DN80	1 1/4"	200	160	39	132	8	19
DN80	1 1/2"	200	160	44.9	132	8	19
DN80	1 3/4"	200	160	50.9	132	8	19
DN80	2"	200	160	56.7	132	8	19
DN80	2 1/2"	200	160	72.3	132	8	19
DN100	1"	220	180	30.3	156	8	19
DN100	1 1/4"	220	180	39	156	8	19
DN100	1 1/2"	220	180	44.9	156	8	19
DN100	1 3/4"	220	180	50.9	156	8	19
DN100	2"	220	180	56.7	156	8	19
DN100	2 1/2"	220	180	72.3	156	8	19
DN100	3"	220	180	85	156	8	19
DN100	3 1/2"	220	180	97.4	156	8	19

规格DIMENSIONS(PN16)

DN	G	ΦA	ΦB	ΦC	ΦD	N	ΦE
DN125	1"	250	210	30.3	184	8	19
DN125	1 1/4"	250	210	39	184	8	19
DN125	1 1/2"	250	210	44.9	184	8	19
DN125	1 3/4"	250	210	50.9	184	8	19
DN125	2"	250	210	56.7	184	8	19
DN125	2 1/2"	250	210	72.3	184	8	19
DN125	3"	250	210	85	184	8	19
DN125	3 1/2"	250	210	97.4	184	8	19
DN125	4"	250	210	110.1	184	8	19
DN125	4 1/2"	250	210	122.8	184	8	19
DN150	1"	285	240	30.3	211	8	23
DN150	1 1/4"	285	240	39	211	8	23
DN150	1 1/2"	285	240	44.9	211	8	23
DN150	1 3/4"	285	240	50.9	211	8	23
DN150	2"	285	240	56.7	211	8	23
DN150	2 1/2"	285	240	72.3	211	8	23
DN150	3"	285	240	85	211	8	23
DN150	3 1/2"	285	240	97.4	211	8	23
DN150	4"	285	240	110.1	211	8	23
DN150	4 1/2"	285	240	122.8	211	8	23
DN150	5"	285	240	135.5	211	8	23

更多型号, 请联系销售团队

For more size, please contact our salesteam.